

Second Floor

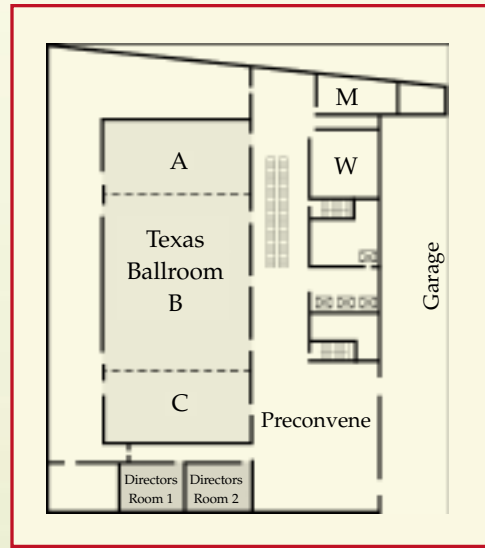

Third Floor

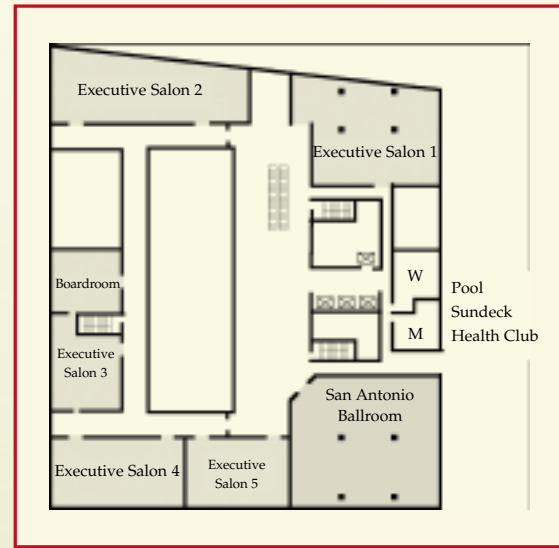

Lower Level

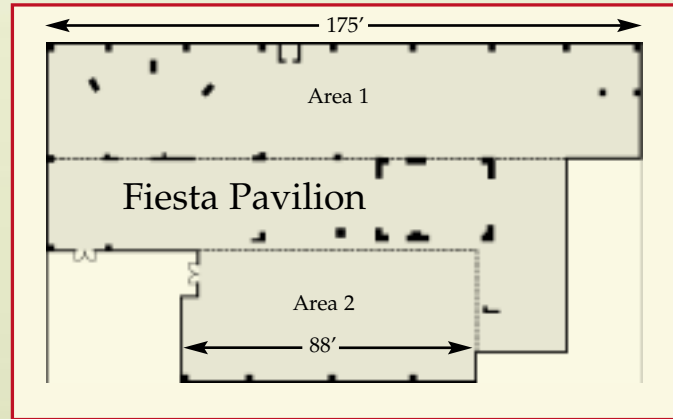

# Crowne Plaza Hotel Riverwalk San Antonio



ROOM	MAXIMUM CAPACITIES						ROOM DIMENSIONS	SQUARE FOOTAGE	CEILING HEIGHT
	BOARDROOM	RECEPTION	CLASSROOM	THEATER	U-SHAPE	BANQUET			
<b>SECOND FLOOR</b>									
Texas Ballroom	n/a	1,000	500	1,000	n/a	640	136'x61'	8,225	15'
Texas A & C (each)	44	183	120	200	45	160	30'x61'	1,830	15'
Texas B	60	464	250	450	70	300	76'x61'	4,636	15'
Directors Room 1	20	53	25	55	18	40	26'x19'	496	10'
Directors Room 2	20	53	25	55	18	40	26'x19'	496	10'
<b>THIRD FLOOR</b>									
Boardroom	22	n/a	n/a	n/a	n/a	n/a	27'x29'	777	10'
Executive Salon 1	50	200	70	180	50	150	50'x43'	1,500	10'
Executive Salon 2	57	175	105	200	50	150	82'x27'	1,800	10'
Executive Salon 3	28	110	40	100	30	50	32'x29'	950	10'
Executive Salon 4	48	150	85	166	50	110	56'x29'	1,585	10'
Executive Salon 5	30	115	60	130	28	80	44'x29'	1,235	10'
San Antonio Ballroom	40	350	150	300	50	230	63'x55'	3,415	12'
<b>LOWER LEVEL</b>									
Fiesta Pavilion	n/a	1,200	450	1,000	n/a	1,000	see diagram	12,800	13'
River Plaza	n/a	90	n/a	n/a	n/a	50	99'x23'	2,272	n/a



**CROWNE PLAZA®**

**RIVERWALK  
SAN ANTONIO**

**THE PLACE TO MEET.**

111 East Pecan Street, San Antonio, Texas 78205  
p 210-354-2800 f 210-362-6444  
crowneplaza.com/sariverwalk

# Meeting Success at Crowne Plaza Riverwalk San Antonio

## DESCRIPTION

Experience the best of South Texas when you hold your next meeting at the Four Diamond Crowne Plaza San Antonio Riverwalk. The Hotel has been given the Gold Key Award by *Meetings and Conventions Magazine* and is truly The Place to Meet™ in downtown San Antonio. The Crowne Plaza is situated on a scenic bend of the famous Riverwalk.

## GENERAL HOTEL SERVICES AND FEATURES

- Complete health club facilities.
- Outdoor pool.
- Sauna, whirlpool.
- High-speed Internet access in all guest rooms.
- 24-hour room service.
- 24-hour business center.
- Gift shop/ATM.
- Priority Club® Member Rewards.
- Remote group check-in capability.
- Covered self parking and valet parking available.
- Complimentary wireless Internet access in hotel lobby area.
- Serving Starbucks® coffee in 111 Bar.

## CONFERENCE ROOMS AND MEETING FACILITIES

- 35,000 total sq. ft. of flexible meeting, banquet and exhibit space.
- 8,200 sq. ft. Grand Ballroom with pre-convene area combined, accommodates up to 1,000 guests.
- 12,800 sq. ft. of meeting and exhibition space accommodating approximately (60) 10x10 exhibit booths and (78) 8x10 exhibit booths.
- 8 Breakout Rooms to accommodate 10-200 people.



## LOCATION

Located on the tranquil north side of the Riverwalk in downtown San Antonio, within walking distance to the Alamo, Convention Center, fine shops and restaurants, the Crowne Plaza San Antonio Riverwalk is the ideal choice location for your next meeting. Business travelers will value the hotel's proximity to many major companies, as well as the variety of services the hotel has to offer. The Hotel is 10 miles from the San Antonio International Airport.

## GUEST ROOM INFORMATION

- 410 luxurious rooms.
- 223 Double/Queen rooms.
- 178 King rooms.
- 2 Hospitality suites with 1,200 total sq. ft.
- 2 One-Bedroom executive suites.
- 5 Two-Bedroom euro-suites.



## GUEST ROOM FEATURES

- Two phones per guest room including one with data port.
- Voice mail.
- High-speed Internet access.
- CD player, AM/FM radio and alarm clock.
- Oversized working desk with lamp.
- Guaranteed wake-up calls.
- In-room movies.
- Complimentary morning newspaper Monday thru Friday.

## SLEEP ADVANTAGE®

The Crowne Plaza Sleep Advantage® Program is the key to the ultimate night's sleep leading to a more productive morning. The program features pillow-top mattresses, European triple sheeting, down and hypo-allergenic pillow selection in each room, various sleep amenities, sleep CD and relaxation tips, plus Quiet Zone Floors.

## BUSINESS CENTER AND SERVICE

- Complimentary full-service business center open 24 hours.
- Business facilities with PC/printer, Internet and email access.

## THE MEETING SUCCESS PROGRAM™

- 2-Hour Response Guarantee – when you contact us, we'll return your initial inquiry within two hours, guaranteed, and provide a proposal by the next business day.
- Crowne Meetings Director – with Crowne Plaza you'll receive expert help from our Crowne Meetings Director from the time you start planning to the time you leave.
- Daily Meeting Debrief – receive a complete itemization of all accounting for the day's expenditures to help you manage your budget.



## DINING

- 111 Bar & Grille – South Texas décor and display kitchen serving breakfast, lunch and dinner.
- 111 Bar – Wine and Martini Bar featuring unique appetizers conducive to South Texas. Serving Starbucks® coffee all day for your enjoyment.
- Pecan Street Pub – featuring wide screen television and all your favorite sporting events.

## HEALTH ACTIVITIES

- Complimentary fitness center, open 24 hours a day, featuring an array of cardio, free weight and aerobic exercise equipment.
- Outdoor pool, whirlpool and indoor sauna.



## GENERAL INFORMATION

- Local currency: USD.
- Time: CST.

## PLACES OF INTEREST

- Alamo.
- Riverwalk, River Taxi stand at entrance to hotel.
- Alamodome.
- Convention Center.
- North Star Mall.
- Sea World.
- Fiesta Texas, Six Flags Amusement Park.
- AT&T Center, home of San Antonio Spurs.
- Splashtown.
- Schlitterbahn water park.
- 25 championship golf courses.
- Shops at La Cantera.



**CROWNE PLAZA®**

**RIVERWALK  
SAN ANTONIO**

**THE PLACE TO MEET.**